



# Simple things on another level.

Excellent location, extensive event space in Springfield, NJ

Hilton Garden Inn Springfield, NJ is conveniently located on Route 22, minutes from Newark Liberty International Airport, renowned golf courses, Short Hills Mall, many restaurants and shopping. New York City's attractions and entertainment are less than a 30-minute drive away. Our hotel offers sophisticated accommodations, friendly service and a casual atmosphere.

- 10,000 sq ft event space, including the Oasis Ballroom
- Indoor heated saline pool
- State-of-the-art fitness center
- The Garden Grille & Bar®  
- *servicing breakfast and dinner daily*
- Room service available 5pm-10pm daily
- 24-hour The Shop
- Complimentary WiFi
- 24-hour business center
- Complimentary parking
- Laundry and valet service

 **Hilton**  
**Garden Inn**™

304 Route 22 West  
Springfield, New Jersey 07081  
973.232.5300  
EWRSP-SalesAdm@Hilton.com  
[www.hgispringfield.hgi.com](http://www.hgispringfield.hgi.com)

# Plan an Event

- 10,000 sq ft event space, including the Oasis Ballroom
- Complimentary WiFi (guestroom & public areas)
- Complimentary parking
- Custom on-site catering services
- In-house state-of-the-art audio visual
- On-site restaurant and bar
- Experienced sales team to guide you through guest accommodation process

## Meeting Space Capacity

	Square Footage	Length	Width	Theatre	Classroom	Conference	Rounds	U-Shape
<b>Oasis</b>								
Oasis A	2,430	45'	54'	200	84	78	160	69
Oasis B	1,350	25'	54'	100	60	43	80	39
Oasis C	2,268	42'	54'	200	84	73	160	65
Oasis Ballroom Ceilings: Perimeter 13'6, Center 15'6, High Middle 17'6	6,048	112'	54'	500	228	194	400	173
<b>Pre-Function</b>								
Summit A	624	26'	24'	20	25	20	30	18
Summit B	1,012	44'	23'	20	25	20	30	29
Summit C	345	15'	23'	20	25	20	30	10
Summit D Ceilings: Perimeter 9'2, Center 9'9	529	23'	23'	20	25	20	30	15
<b>Springfield Room</b> Ceilings: Perimeter 9'6, Center 10'	1014	26'	39'	80	42	32	70	29
<b>Conservatory Boardroom</b> Ceilings: 11'	408	17'	24'					
<b>Livingston Room</b> Ceilings: 7'8	143	13'	19'	16	6	-	12	4
<b>Fanwood Boardroom</b> 10 Chairs, Ceilings: 7'8	529	23'	23'					
<b>Westfield Room</b> Ceilings: 7'8	210	14'	15'	23	9	-	10	6

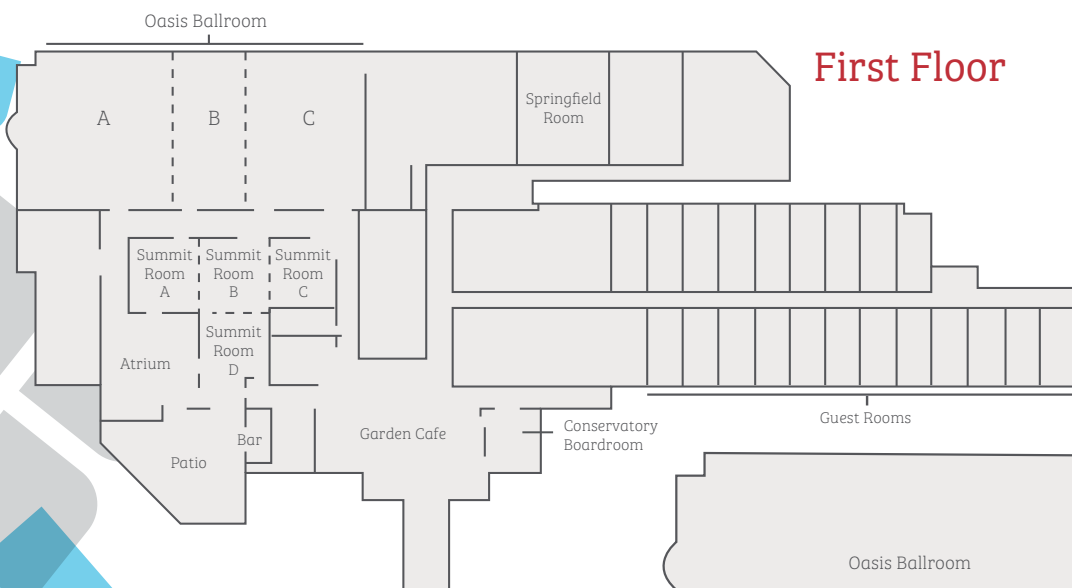

First Floor

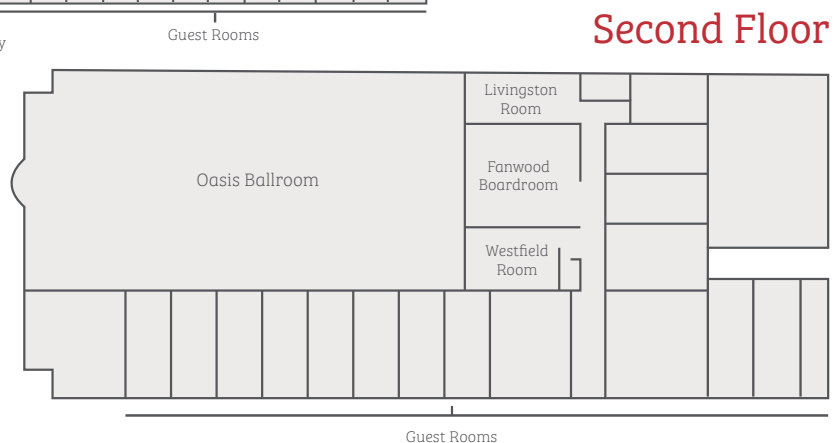

Second Floor